

"The Waterford"
\$268,450
12002 Weatherford Dr

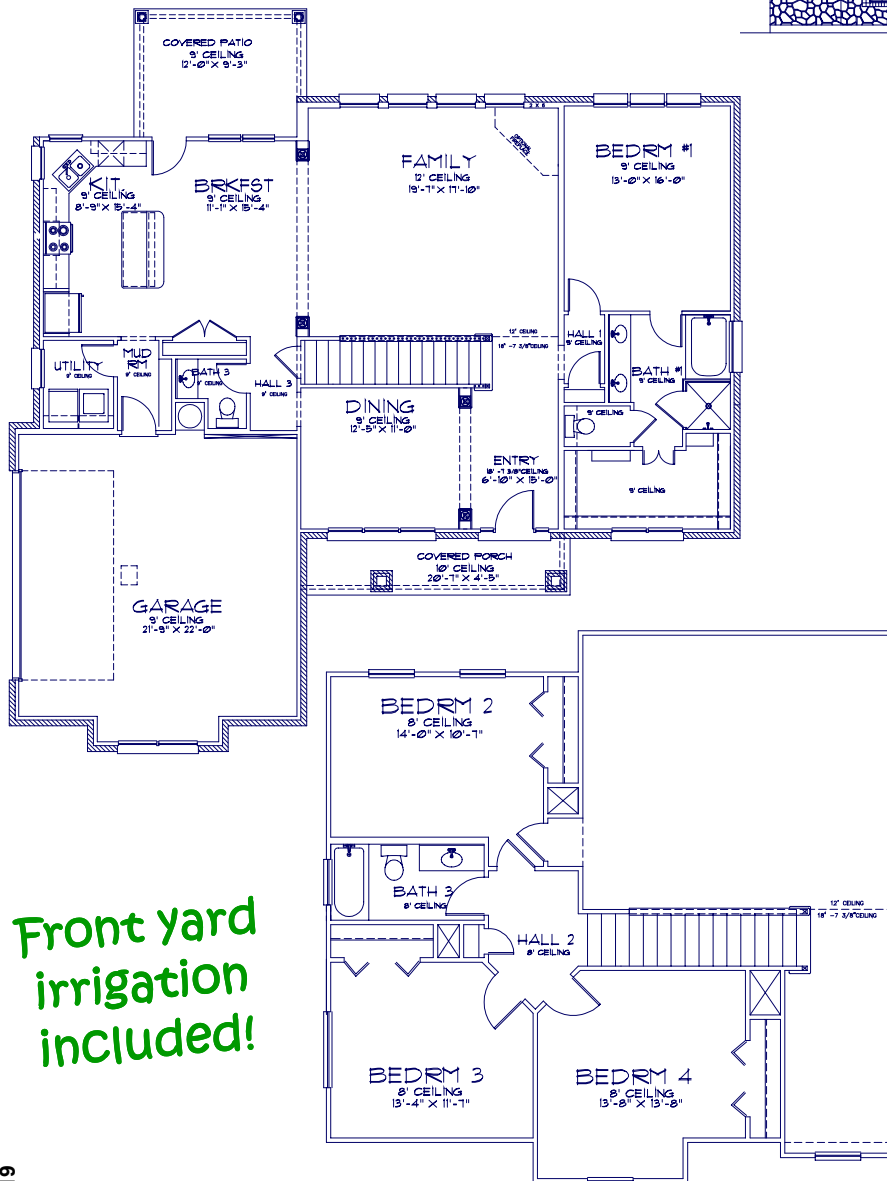

Front yard
irrigation
included!

Plan Features

- 4 Bedroom, 2.5 Bathroom
- Side Entry Garage
- Private Master Suite Downstairs
 - Double Vanity
 - Garden Bathtub
 - Separate Shower
- Spacious Family Room
- Large Open Kitchen
 - Center Island
 - Breakfast Area
 - Granite Countertops
- Stainless Steel Appliances
- Formal Dining Room
- Ceramic Tile Throughout
- Mud Room & Separate Utility Room
- Low-E Vinyl Windows
- Security System Pre-wire
- Large Covered Front Porch
- Corner Lot w/in Cul-de-sac
- Foundation Termite Pre-Treatment

Neighborhood Features

- Lakewood Communities
- Neighborhood Pool
- Soccer Fields
- 1/2 Acre Lots
- Belton School District
- Homeowners Association

WALKING DISTANCE TO LAKEWOOD ELEMENTARY!



Plans, elevations, features and options are subject to change. Plan dimensions, brick coverage and flooring may vary by subdivision. Some listed features and options may not be available on this home and/or are subject to change. Consult Omega representative and working drawings for actual dimensions, features, options and other information. Elevation is conceptual drawing only. © Copyright 2006 Omega Builders.

(254) 771-2296
www.omegabuilders.com